



Microsoft LifeCam Studio Webcam

Each individual workspace/monitor will be pre-installed with the Microsoft LifeCam Studio Webcam/Microphone.

Review the notes below to utilize your webcam during a Teams meeting:

- Before joining a Teams meeting, review the Device Settings located in three dot icon.
- Once the Settings screen opens, select the “Devices” button and the available video and audio selections will appear.
 - ◊ To utilize the Microsoft LifeCam Studio webcam, ensure it is selected as your camera option.
 - ◊ It is **recommended** to use your connected Bluetooth/wired headset or the “Microsoft LifeCam Studio” option as the microphone selection for Teams meetings.
 - ◊ It is also recommended to set the “Noise Suppression” setting as High to mitigate any background noise during your meetings.

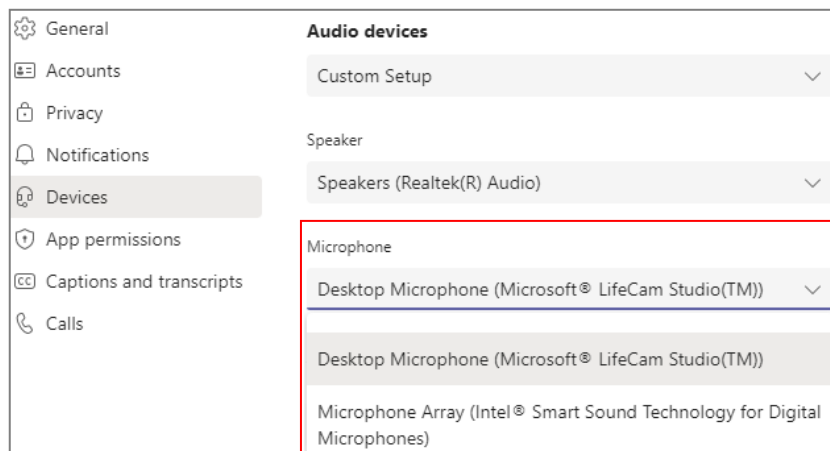
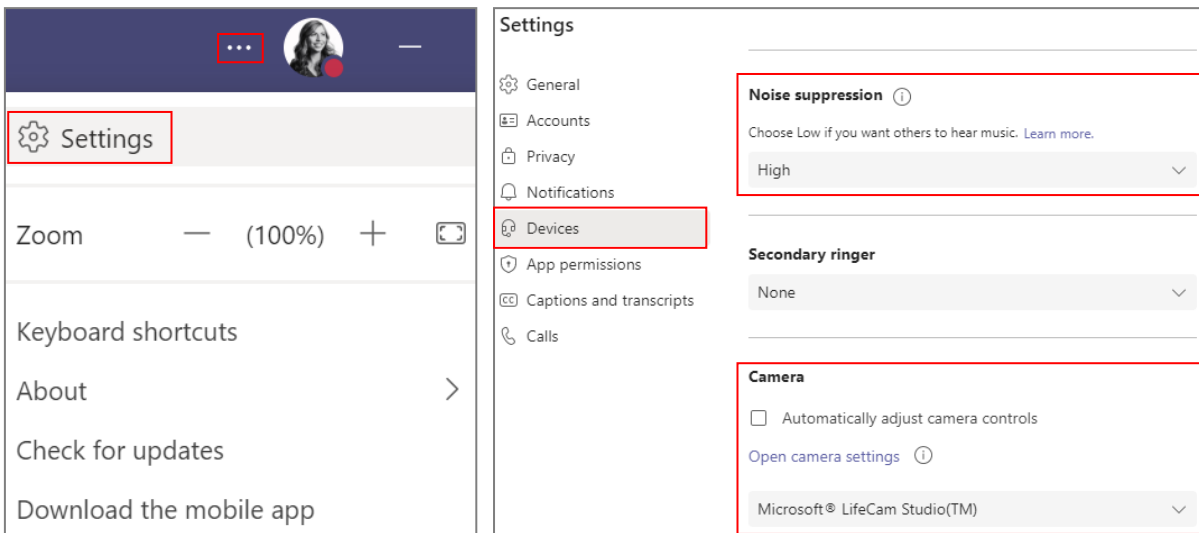



Logitech MX Anywhere 3 Wireless Mouse

Each assigned workspace will be provided with a new Logitech MX Anywhere 3 wireless mouse.

The features of the wireless mouse are listed below:

- Comfort: Low-profile design contoured for your hand, with ultra-soft silicon side grips
- Track on virtually any surface: Work seamlessly anywhere
- Stay powered up to 70 days on a full charge – and get 3 hours of use from a 1-minute quick charge via the wired USB charging cable



Follow the steps below to set-up your wireless mouse:

To set-up your mouse via Bluetooth:

1. Select the Windows icon, then select Settings.
2. Select Devices, then Bluetooth in the left pane.
3. In the list of Bluetooth devices, select the Logitech device you want to connect to and select Pair. Follow the onscreen instructions to finish pairing.

To set-up your mouse with the wireless USB receiver:

- Plug the receiver into a USB port on your monitor, computer, or docking station and start using your mouse.